



Wear Management Solutions

For Industrial Abrasion Resistance, Corrosion
Protection and Wear & Impact Protection

WWW.CRDCREIGHTON.COM | Call: 905-673-8200

UL700+™ is high Chromium & Molybdenum white iron with hardness Brinell 700+ bonded to mild steel by vacuum brazing, products include chocky bar, wear bar, wear plate, bolt protector donut, roll bar and customized shapes & sizes. Large size wear liners are available.

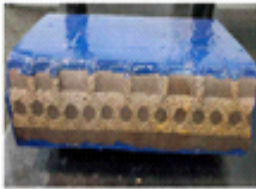

Cerasite™ is a name of special cast parts with ceramic inserts, products range impact crusher blow bars, clink hammers and wear liners .

Castbond™ is specialized in clad pipe with high chrome white iron inlay cast bonded with mild steel shell. This line is a special solution for piping system requesting high pressure plus high abrasion. Product ranged with pipe, elbow, reducer etc.



Tribond™ introduce 3 in 1 (high chrome white iron, ceramic and mild steel) solution for tough applications. All parts combined high chrome white iron with ceramic inserts and vacuum brazed onto mild steel, and all parts are weldable.

Chocky bar

Part No.	A	B	C	D	E	Weight (kgs)
CB25	240	25	15	8	23	0.90
CB40	240	40	15	8	23	1.50
CB50	240	50	15	8	23	1.90
CB65	240	65	15	8	23	2.50
CB90	240	90	15	8	23	3.50
CB100	240	100	15	8	23	3.90
CB130	240	130	15	8	23	5.15
CB150	240	150	15	8	23	6.2

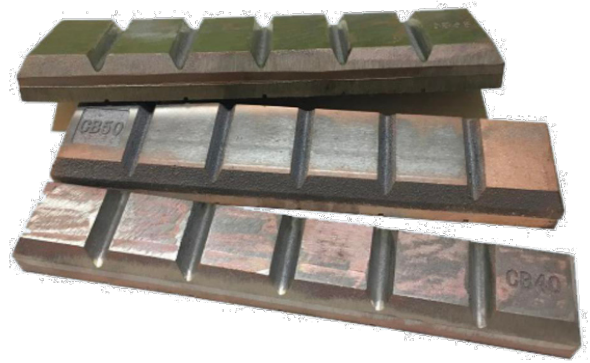
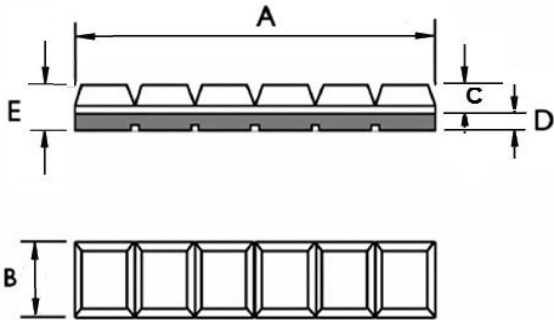

Solid Chocky bar

Part No.	A	B	C	D	E	Weight(kgs)
CB25S	240	25	15	8	23	1.10
CB40S	240	40	15	8	23	1.70
CB50S	240	50	15	8	23	2.20
CB65S	240	65	15	8	23	2.90
CB90S	240	90	15	8	23	3.90
CB100S	240	100	15	8	23	4.40

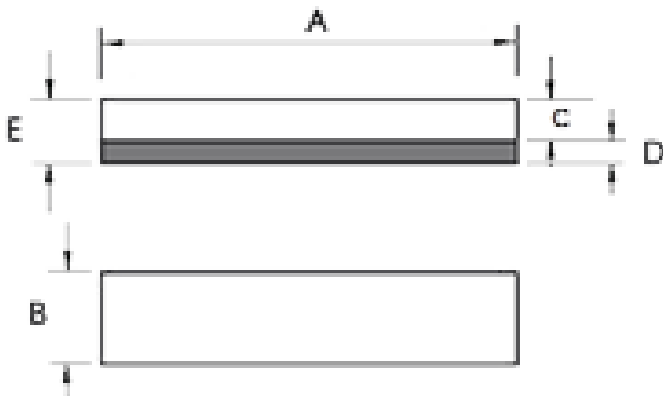

Wear bar

Part No.	A	B	C	D	E	Weight (kgs)
DLP 919	200	25	15	10	25	1.0
DLP 1191	300	25	15	10	25	1.5
DLP 295	153	38	25	8	33	1.5
DLP 4	300	38	25	8	33	3.0
DLP 271	203	50	12	8	20	1.6
DLP 270	254	50	12	8	20	2.0
DLP 508	190	50	20	10	30	2.2
DLP 2199	65	50	38	12	50	1.3
DLP 2265	115	50	38	12	50	2.3
DLP 337	127	50	38	12	50	2.4
DLP 1101	150	50	40	10	50	2.9
DLP 343	190	50	40	10	50	3.7
DLP 369	210	50	38	12	50	4.1
DLP 125	230	50	38	12	50	4.5
DLP 453	294	50	40	10	50	5.8
DLP 2017	300	50	40	10	50	5.9
DLP 201A	432	50	38	12	50	8.5
DLP 2230	600	50	38	12	50	11.8
DLP 965	250	60	12	8	20	2.4
DLP 184	150	75	29	10	39	3.4
DLP 528	150	75	40	10	50	4.4
DLP 619	150	75	50	10	60	5.3
DLP 450	294	80	38	12	50	9.2
DLP 451	194	80	38	12	50	6.1
DLP 392/20	241	100	38	20	58	11.0

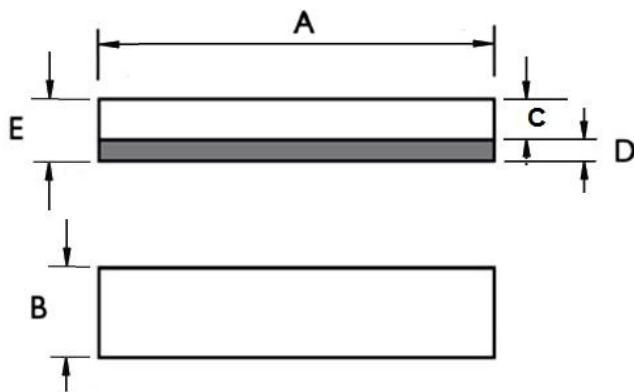

Wafer strip

Part No.	A	B	D	E	Weight (kgs)
WS 25	240	25	6	12	0.6
WS 40	240	40	6	12	0.9
WS 50	240	50	6	12	1.2
WS 65	240	65	6	12	1.5

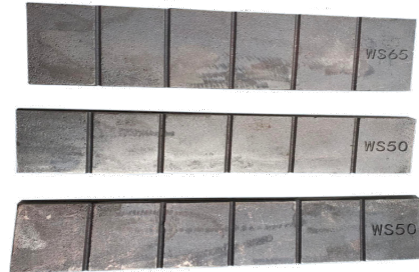
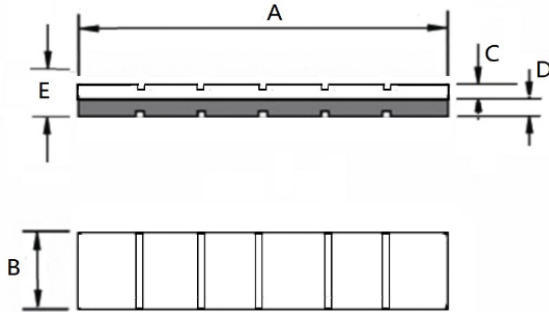

Skid bar

Part No.	Type	A	B	C	D	E	Weight (kgs)
Rectangular Type 1							
SB 403	1	214	101	22	12	34	5.1
SB 406	1	302	101	22	12	34	7.3
SB 409	1	154	101	22	12	34	3.7
SB 205	1	279	75	22	12	34	6.1
Herringbone Type 2							
SB 404L	2	214	101	22	12	34	5.9
SB 405R	2	214	101	22	12	34	5.9
SB 407L	2	302	101	22	12	34	8.4
SB 408R	2	302	101	22	12	34	8.4
SB 410L	2	154	101	22	12	34	4.2
SB 411R	2	154	101	22	12	34	4.2
Domed Edge Type 3							
SB 412	3	250	150	20	25	45	13.1
SB 413	3	200	150	20	25	45	10.5
SB 414	3	250	250	20	25	45	21.9

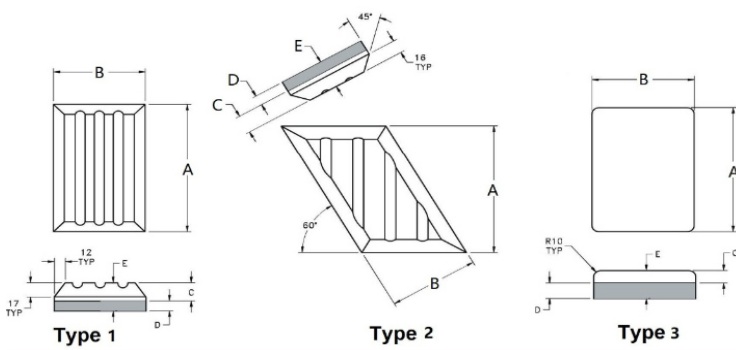

Octagon Buttons

Part No.	Wght (kg)	A(mm)	B(mm)	C(mm)	D(mm)	E(mm)
OTB1027	1.1	81	75	12	15	27
OTB1232	2.1	125	115	12	20	32
OTB1038	2.4	103	95	12	26	38
OTB1641	4.7	163	150	12	29	41
OTB1051	3.1	103	95	20	31	51

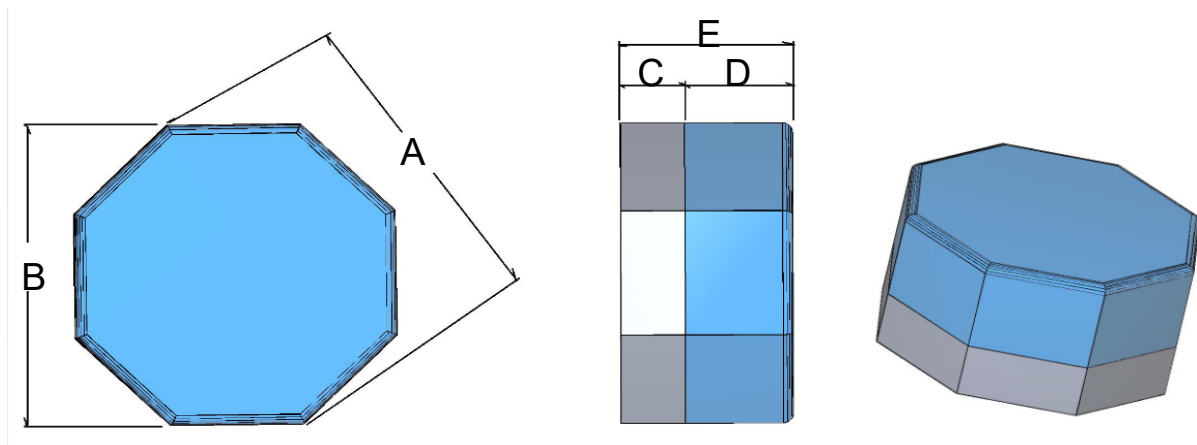

Wear button

Part No.	A	B	C	D	E	Weight (kgs)
WB60	60	40	20	10	30	0.7
WB75	75	55	20	10	30	1.0
WB75-27	75	55	17	10	27	0.9
WB90	90	70	20	10	30	1.5
WB90-32	90	70	20	12	32	1.6
WB115	115	95	20	12	32	2.6
WB150	150	130	25	16	41	5.7
WB150-32	150	130	20	12	32	4.5

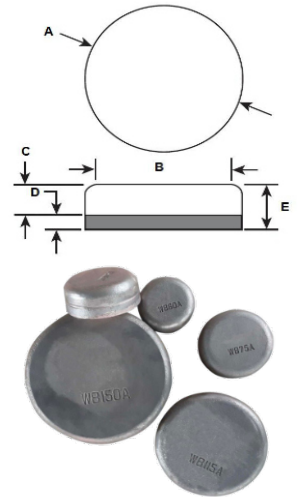

Donuts (Bolt protector)

Part No.	A	B	C	D	E	Weight (kgs)
DLP 1920	75	25	17	8	25	0.7
DLP 1921	100	50	17	8	25	1.0
DLP 1994	100	70	24	8	32	1.0
DLP 2196	130	80	15	8	23	1.3
DLP 4471	148	108	25	10	35	2.2

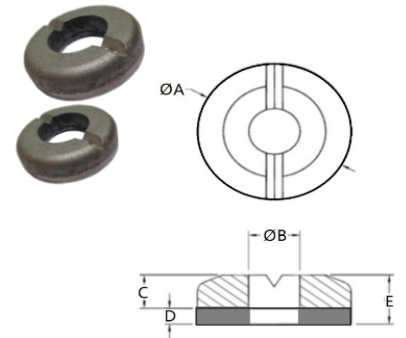

Roll bar

Part No.	A	B	C	D	Weight (kgs)
RB4091	229	32	19	8	2.0
RB4092	305	51	38	8	7.9
RB4093	305	76	63.5	8	10.2
RB4094	305	127	127	8	29.6

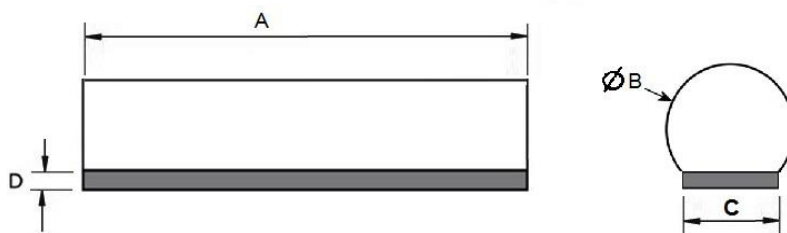

Grizzly bar

Part No.	TYPE	A	B	C	D	E	Weight (kgs)
Type A - 150/50 taper							
DLP 2067	A	150.0	137.5	-	-	-	13.6
DLP 2068	A	137.5	125.0	-	-	-	12.5
DLP 2069	A	125.0	112.5	-	-	-	11.2
DLP 2070	A	112.5	100.0	-	-	-	10.0
DLP 2071	A	100.0	87.5	-	-	-	8.8
DLP 2072	A	87.5	75.0	-	-	-	7.5
DLP 2073	A	75.0	62.5	-	-	-	6.3
DLP 2074	A	62.5	50.0	-	-	-	5.1
Type B - 150/75 taper							
DLP 2075	B	150	141	-	-	-	13.8
DLP 2076	B	141	131	-	-	-	12.9
DLP 2077	B	131	122	-	-	-	11.9
DLP 2078	B	122	113	-	-	-	11.1
DLP 2079	B	113	103	-	-	-	10.1
DLP 2080	B	103	94	-	-	-	9.2
DLP 2081	B	94	84	-	-	-	8.3
DLP 2082	B	84	75	-	-	-	7.4
Type C - 180/120 taper							
DLP 2083	C	180	171	-	-	-	18.5
DLP 2084	C	171	163	-	-	-	17.6
DLP 2085	C	163	154	-	-	-	16.7
DLP 2086	C	154	146	-	-	-	15.8
DLP 2087	C	146	137	-	-	-	14.9
DLP 2088	C	137	128	-	-	-	13.9
DLP 2089	C	128	120	-	-	-	13.0

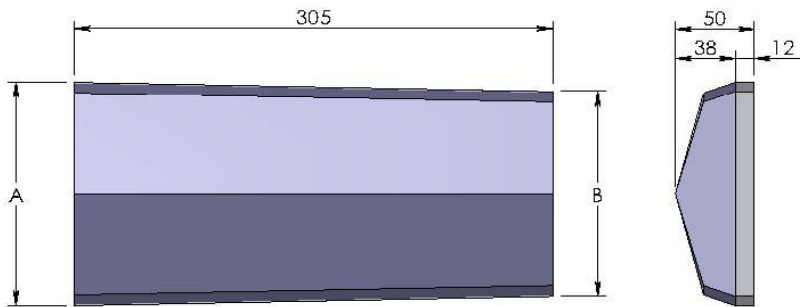

STANDARD GRIZZLY BAR



TYPE A - GRIZZLY BAR ASSEMBLY



TYPE B - GRIZZLY BAR ASSEMBLY

Wear Plate

Part No.	A	B	C	D	E	Weight (kg)
LN19	190	190	15	8	23	6.80
LN20	200	404	15	8	23	14.80
LN24	245	495	15	8	23	21.95
LN39	390	390	15	8	23	27.60
LN40	404	404	15	8	23	29.70
LN49	495	495	15	8	23	44.50
LN50	500	395	15	8	23	35.70
LN55	505	300	15	8	23	27.50
LN60	600	300	15	8	23	32.6

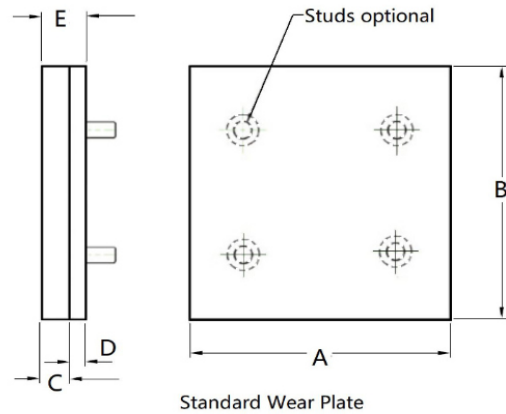

Rockbox Liner (Wear strap)

Part No.	A	B	C	D	E	F
WP300	300	300	40	10	50	50
WP150	150	300	40	10	50	50
WP296	296	296	40	10	50	50
WP146	146	296	40	10	50	50
WP452	452	452	40	10	50	50
WP148	148	452	40	10	50	50
WP516	516	447	25	10	35	25
WP368	368	516	25	10	35	25
WP520	520	451	50	10	60	50

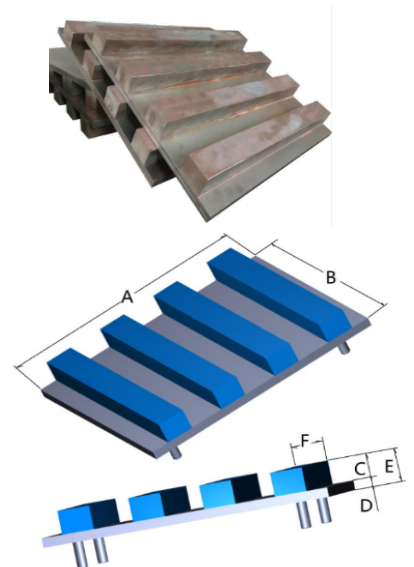

Customized Wear Runner for quick replacement

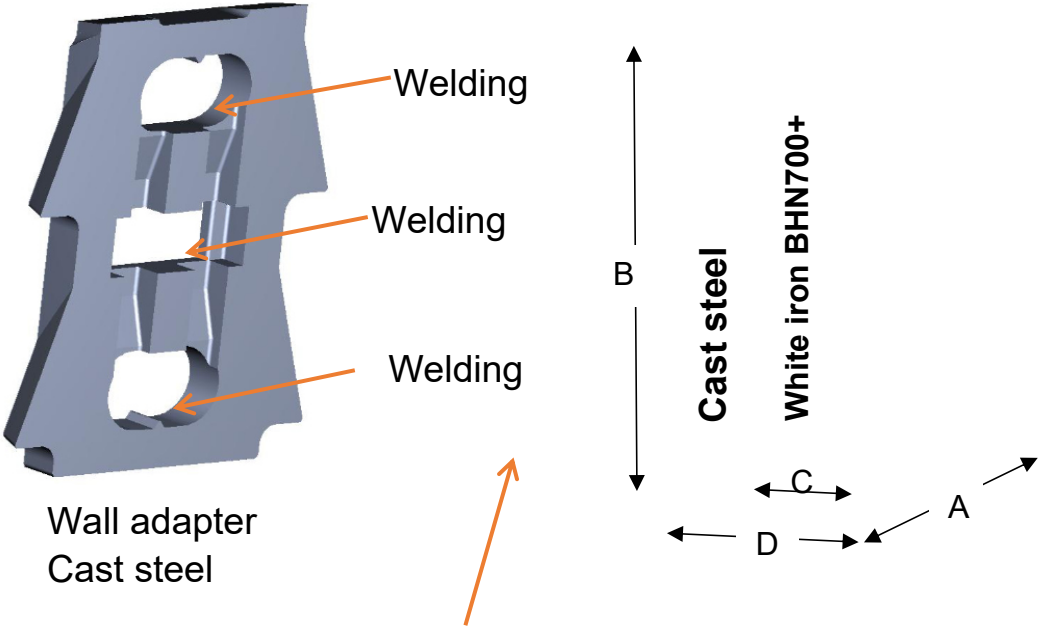

Pattern No.	Width A (mm)	Height B (mm)	CWI Thickness C (mm)	RUNNER Thickness D (mm)	Weight of Runner (kg)	Weight of Wall adapter (kg)
WR50	153	159	41	81	10.7	2.1
WR60	203	210	41	81	18.8	3.6
WR70	267	279	55	100	43.9	6.3
WR90	330	360	75	120	87.1	10.1

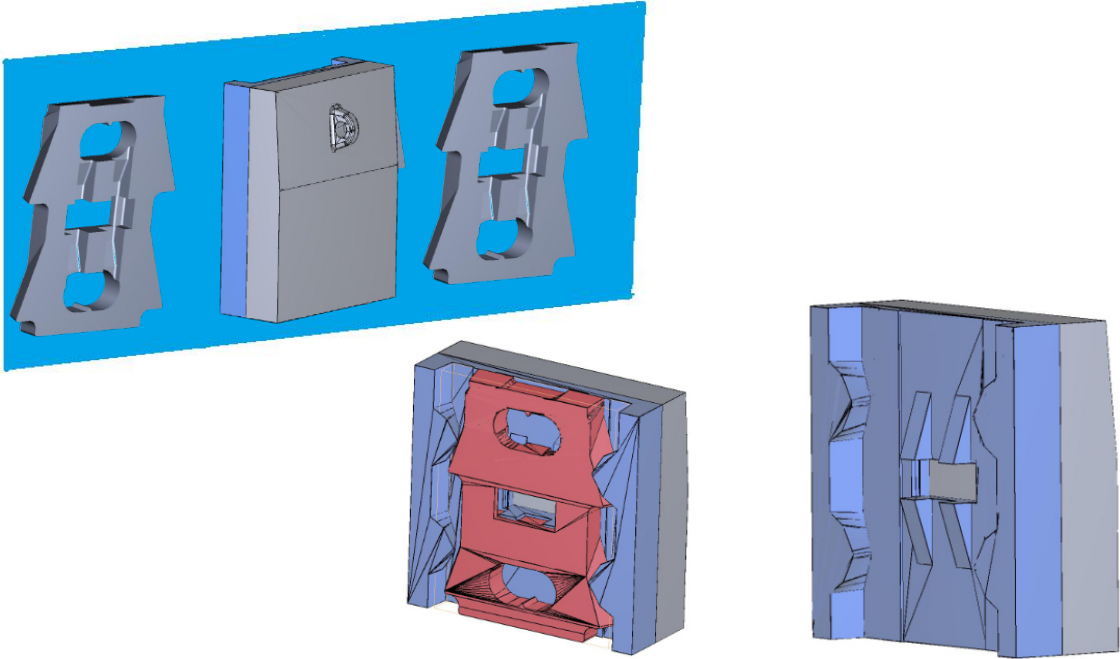

Star Plate

Part No.	TYPE	A	B	C	D	E	Weight(Kgs)
DLP 2180	1	400	400	15	8	23	28.7

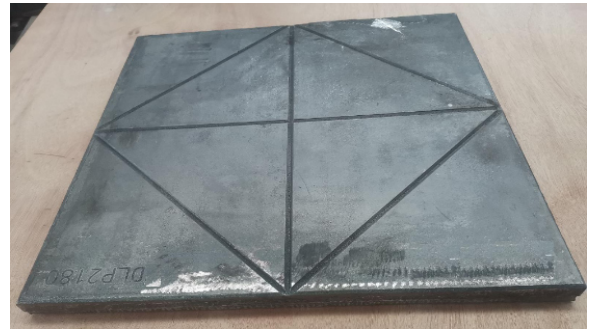
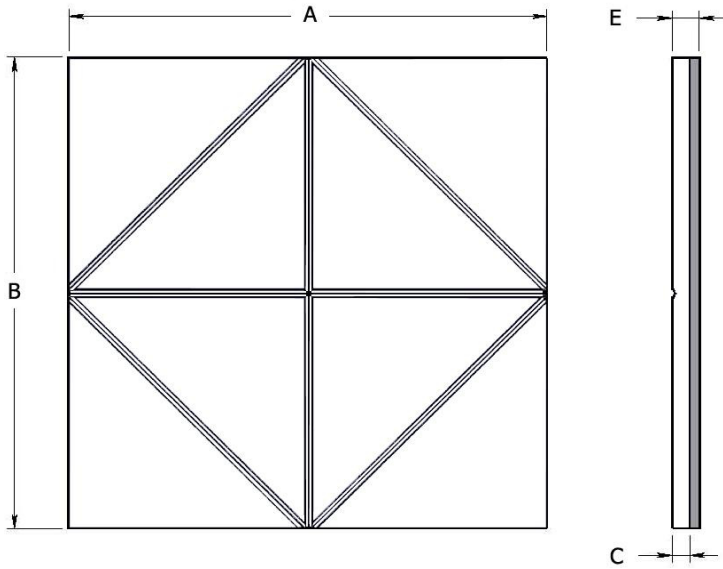

Thin Ultimate Tiles

Part No.	TYPE	A	B	C	D	E	Weight(kgs)
DLP 2747	2	200	200	6	6	12	3.8
DLP 2748	2	300	300	6	6	12	8.5

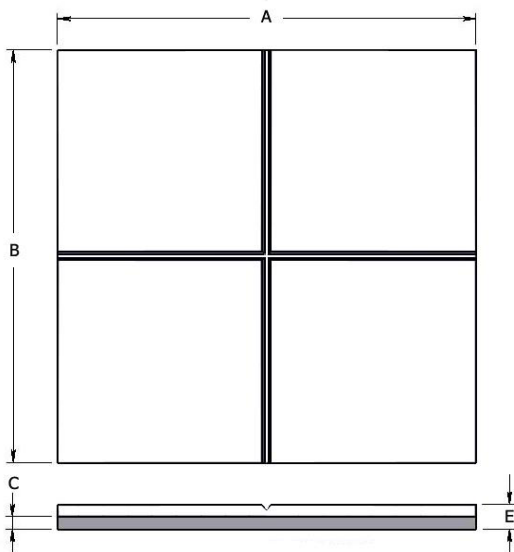

Large Size Bimetallic Wear Liner

Description: Chrome Moly casting white iron vacuum brazed to mild steel backing plate

Hardness: Brinell 700+

Main application: hopper/chute liner for wear & impact protection

Installing method: arc weld or stud/bolt

Customized size & shape available

Length & width: no limitation.

Size Chart of standard thickness (mm)																
White iron Steel backing	6	8	10	12	14	16	18	24	30	40	60	60	80	100	120	150
6	Y	Y	Y	Y	Y	Y	Y	Y	Y	Y	Y	Y				
8	Y	Y	Y	Y	Y	Y	Y	Y	Y	Y	Y	Y				
10	Y	Y	Y	Y	Y	Y	Y	Y	Y	Y	Y	Y				
12		Y	Y	Y	Y	Y	Y	Y	Y	Y	Y	Y				
14			Y	Y	Y	Y	Y	Y	Y	Y	Y	Y				
16				Y	Y	Y	Y	Y	Y	Y	Y	Y	Y			
18				Y	Y	Y	Y	Y	Y	Y	Y	Y	Y	Y		
20					Y	Y	Y	Y	Y	Y	Y	Y	Y	Y	Y	Y
25					Y	Y	Y	Y	Y	Y	Y	Y	Y	Y	Y	Y
30					Y	Y	Y	Y	Y	Y	Y	Y	Y	Y	Y	Y

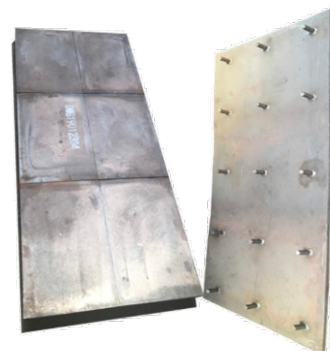

Custom Design & Fabrication

Description:
design and fabrication of
chute/hopper/bin etc.

Material:
AR plate, QT plate, UL700+,
CCO plate and castings etc.
Customized size available

